

NOTE: Zinc 3Cr. Plated and Black 3Cr. Plated are RoHS compliant trivalent finishes

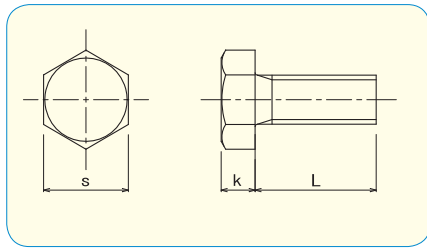

RoHS Directive Compliance

HEX HEAD CAP SCREW JIS B1180 appendix [Full Thread]



- **Material · plating**
 Steel 4.8 / Zinc 3Cr. Plated
 Steel 4.8 / Zinc Black 3Cr. Plated



How to order or inquire: R830-B1180F-finish code diameter x length

Example: R830-B1180F-CR3 4x16

Finish codes: CR3 for Zinc 3Cr. Plated, CR3B for Black 3Cr. Plated

	M3	M4	M5	M6	M8	M10	M12	M14	M16
s	5.5	7	8	10	13	17	19	22	24
k	2	2.8	3.5	4	5.5	7	8	9	10

d		pcs / Box							
L	M3	M4	M5	M6	M8	M10	M12	M14	M16
6	5000	2000	1000						
8	5000	2000	1000	500					
10	4000	1000	1000	800	300				
12	2000	1000	1000	800	400				
14		1000	1000	800	350				
15	2000	1000	1000	700	350	200			
16	2000	1000	1000	700	350	200			
18		1000	500	700	300				
20	1000	1000	500	600	300	200	100		
22	1000	1000	500	600					
25	1000	1000	500	600	300	200	100	100	70
30	1000	1000	500	500	300	200	100	90	60
35	1000	500	500	450	200	150	100	80	50
40		500	500	400	250	100	100	70	50
45		500	200	350	250	100	100	70	50
50		200	200	300	250	100	100	60	50
55			200	250	200	100	50	50	40
60			200	250	200	100	50	50	40
65			200	250	200	100	50	50	40
70				200	100	100	50	50	40
75				200	100	100	50	50	40
80				250	100	100	50	40	40
85					150				
90				200	150	90	50	40	40
100				200	150	80	50	30	30
110				200	100	70	50		
120				150	100	70	50		
130				150	100	60	40		
140				150	100	60	40		
150				150	100	60	40		

HEX HEAD CAP SCREW JIS B1180 appendix [Full Thread]



RoHS Directive Compliance

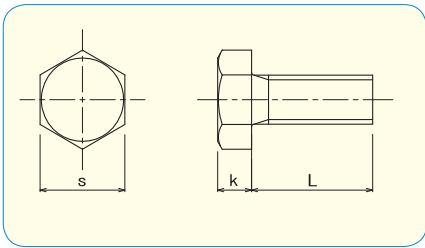

●Material
Stainless Steel A2



How to order or inquire: R830-B1180F-material code diameter x length

Example: R830-B1180F-A2 4x16

Material codes: A2 for Stainless Steel A2

	M3	M4	M5	M6	M8	M10	M12	M14	M16	M18	M20	M24	M30
s	5.5	7	8	10	13	17	19	22	24	27	30	36	46
k	2	2.8	3.5	4	5.5	7	8	9	10	12	13	15	19

d		pcs / Box												
L	d	M3	M4	M5	M6	M8	M10	M12	M14	M16	M18	M20	M24	M30
6		2000	1000	1000										
8		2000	1000	1000	700									
10		2000	1000	1000	400	200								
12		2000	1000	500	400	200								
14			1000	500	400	200								
15		1500	1000	500	400	200	100							
16		1500	1000	500	400	200	100							
18			500	500	300	200	100							
20		1000	500	500	300	200	100	100						
22				500	300	200								
25		1000	500	300	300	200	100	100	50	50				
30		1000	500	300	300	100	100	100	50	50	40	35		
35		1000	300	300	300	100	100	100	100	50	40	35		
40		1000	300	200	300	100	100	100	50	50	40	35		
45			300	200	200	100	100	100	50	50	30	30		
50			200	200	200	100	100	50	50	50	30	30		12
55			200	200	200	100	100	50	50	40	30	25		12
60			200	200	200	100	100	50	50	30	30	25	20	10
65				200	200	100	100	50	40	30	25	25	20	10
70				150	100	100	50	50	40	30	25	20		10
75				150	100	100	50	50	40	30	25	20		
80				150	100	100	50	50	30	30	25	20		
85				150	100	100	50	50		30		20		
90				100	100	100	50	50	30	30	20	20		
100				100	100	100	50	50	30	30	20	20		
110					150	50	50	25		20		15		
120					150	50	50	40		20		15		
130					150	50	50	30		20		15		
140					150	50	50	30		20		15		
150					150	50	50	30		20		15		
160						50	40	30		15				
170						50	40	30		15				
180						50	40	30		15				
190						50	40	30						
200						50	40	30		15				
210								25						
220								25		10				
230								25						
250							30	25		10				
300							30	25		10				



RoHS Directive Compliance

HEX HEAD CAP SCREW JIS B1180 appendix [Partial Thread]

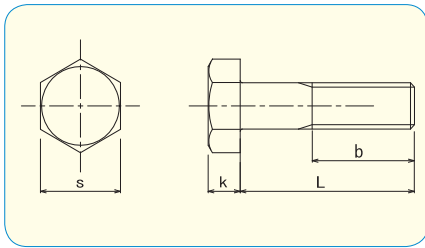

- **Material · plating**
 Steel 4.8 / Zinc 3Cr. Plated
 Steel 4.8 / Zinc Black 3Cr. Plated

How to order or inquire: R830-B1180P-finish code diameter x length

Example: R830-B1180P-CR3 4x16

Finish codes: CR3 for Zinc 3Cr. Plated, CR3B for Black 3Cr. Plated

	M8	M10	M12	M14	M16	M18	M20	M22	M24
s	13	17	19	22	24	27	30	32	36
k	5.5	7	8	9	10	12	13	14	15

pcs / Box

L \ d	M8	M10	M12	M14	M16	M18	M20	M22	M24
25									
30	300	200							
35	200	150	100						
40	250	100	100	70					
45	250	100	100	70	1				
50	250	100	100	60	1	1			
55	200	100	50	50	1	1	1		
60	200	100	50	50	1	1	1	1	
65	200	100	50	50	1	1	1	1	1
70	100	100	50	50	1	1	1	1	1
75	100	100	50	50	1	1	1	1	1
80	1	1	1	1	1	1	1	1	1
85	1	1	1	1	1	1	1	1	1
90	1	1	1	1	1	1	1	1	1
100	1	1	1	1	1	1	1	1	1
110	1	1	1	1	1	1	1	1	1
120	1	1	1	1	1	1	1	1	1
130	1	1	1	1	1	1	1	1	1
140	1	1	1	1	1	1	1	1	1
150	1	1	1	1	1	1	1	1	1
160					1			1	1
170	1				1		1	1	1
180					1		1	1	1
190					1		1	1	1
200					1		1	1	1

HEX HEAD CAP SCREW JIS B1180 appendix [Partial Thread]



RoHS Directive Compliance

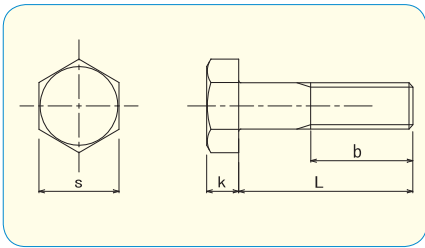

● Material
Stainless Steel A2



How to order or inquire: R830-B1180P-material code diameter x length

Example: R830-B1180P-A2 4x16

Material codes: A2 for Stainless Steel A2

	M6	M8	M10	M12	M14	M16	M18	M20	M22	M24	M30
s	10	13	17	19	22	24	27	30	32	36	46
k	4	5.5	7	8	9	10	12	13	14	15	19

d		pcs / Box										
L	d	M6	M8	M10	M12	M14	M16	M18	M20	M22	M24	M30
30			100									
35				100								
40			100	100	100	50				20	15	
45				100	100	50	50			20	15	
50			100	100	50	50	50		30	20	15	
55			100	100	50	40	40		25	20	15	
60			100	100	50	40	30	30	25	20	15	
65			100	100	50	40	30	25	25	20	15	
70			100	50	50	30	30	25	20	15	15	
75			100	50	50	40	30	25	20	15	15	10
80	100	100	100	50	50	30	30	25	20	15	15	10
85	100	100	100	50	50		30	20	20	15	15	8
90	150	100	100	50	50	30	30	20	20	15	10	8
100	150	100	100	50	50	30	30	20	20	15	10	8
110	150	50	100	50	40		20		15	10	10	8
120	150	50	100	50	40		20		15	10	10	8
130	150	50	100	50	40		20		15	10	10	6
140	150	50	100	50	40		20		15	10	10	6
150	150	50	100	50	40		20		15	10	10	6
160		50	100	40	30		20		15	10	10	6
170		50	100	40	30		20		15	10	1	1
180		50	100	40	30		15		15	10	1	1
190		50	100	40	30		20		15	10	1	1
200		50	100	40	30		20		15	10	1	1
210		50	100	30	25		10		1	1	1	1
220		50	100	30	25		10		1	1	1	1
230		50	100	30	25		10		1	1	1	1
240		50	100	30	25		10		1	1	1	1
250		50	100	30	25		10		1	1	1	1
260			100	30	25				1	1	1	1
270			100	30	25				1	1	1	1
280			100	30	25				1	1	1	1
290			100	30	25							
300			100	30	25		10					
310					20							
320					20							
330					20							
340					20							
350					1							

SUS 316L

HEX HEAD CAP SCREW JIS B1180 appendix

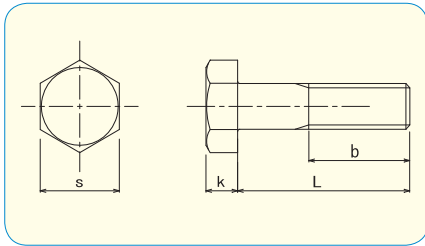

● **Material**

SUS 316L Stainless Steel A4



RoHS Directive Compliance



How to order or inquire: R830-B1180-material code diameter x length

Example: R830-B1180-316L 4x16

Material codes: 316L for Stainless Steel 316L

	M3	M4	M5	M6	M8	M10	M12	M14	M16	M18	M20
s	5.5	7	8	10	13	17	19	22	24	27	30
k	2	2.8	3.5	4	5.5	7	8	9	10	12	13

L \ d		M3	M4	M5	M6	M8	M10	M12	M14	M16	M18	M20	pcs / Box
6	6	300	300	200									
8	8	300	300	200									
10	10	300	300	200	200	200							
12	12	300	300	200	200	200							
14	14		300	200	200	200							
15	15	300	300	200	200	200	100						
16	16	300	300	200	200	200	100	50					
18	18		300	200	200	200							
20	20	300	300	200	200	200	100	50					
22	22		300	200	200	200							
25	25	300	300	200	200	200	100	50	50	50			
30	30	300	300	200	200	200	100	50	50	50	30	30	
35	35		300	200	200	200	100	50	50	50	30	30	
40	40		300	200	200	200	* 100	* 50	50	50	30	30	
45	45		300	200	200	200	* 100	* 50	* 50	50	30	30	
50	50		300	200	200	200	* 100	* 50	* 50	* 50	30	30	
55	55			200	200	200	* 100	* 50	* 50	* 50	30	30	
60	60			200	200	200	* 100	* 50	* 50	* 50	* 30	* 30	
65	65			200	200	200	* 100	* 50	* 50	* 50	* 30	* 30	
70	70				200	200	* 100	* 50	* 50	* 50	* 30	* 30	
75	75			200	200	200	* 100	* 50	* 50	* 50	* 30	* 30	
80	80				200	* 200	* 100	* 50	* 50	* 50	* 30	* 30	
85	85				200	* 200	* 100	* 50	* 50	* 50	* 30	* 30	
90	90				200	* 200	* 100	* 50	* 50	* 50	* 30	* 30	
95	95				200	* 200	* 100	* 50	* 50	* 50	* 30	* 30	
100	100				200	* 200	* 100	* 50	* 50	* 50	* 30	* 30	
105	105						* 100	* 50		* 50		* 30	
110	110					* 200	* 100	* 50	* 50	* 50	* 30	* 30	
115	115						* 100	* 50		* 50		* 30	
120	120					* 200	* 100	* 50	* 50	* 50	* 30	* 30	
125	125						* 100	* 50		* 50		* 30	
130	130					* 200	* 100	* 50	* 50	* 50	* 30	* 30	
135	135						* 100	* 50		* 50		* 30	
140	140					* 200	* 100	* 50	* 50	* 50	* 30	* 30	
150	150					* 200	* 100	* 50	* 50	* 50	* 30	* 30	
160	160						* 100	* 50	* 50	* 50	* 30	* 30	
170	170						* 100	* 50	* 50	* 50	* 30	* 30	
180	180						* 100	* 50	* 50	* 50	* 30	* 30	
190	190						* 100	* 50	* 50	* 50		* 30	
200	200						* 100	* 50	* 50	* 50	* 30	* 30	
210	210							* 50		* 50		* 30	
220	220							* 50		* 50		* 30	
230	230							* 50		* 50		* 30	
250	250						* 100	* 50	* 50	* 50		* 30	
280	280									* 50		* 30	
300	300									* 50		* 30	



HEX HEAD CAP SCREW JIS B1180 appendix

How to order or inquire: R830-B1180-material code diameter x length

Example: R830-B1180-316L 4x16

Material codes: 316L for Stainless Steel 316L

	M22	M24	M27	M30
s	32	36	41	46
k	14	15	17	19

L \ d	M22	M24	M27	M30
40	30	20		
45	30	20		
50	30	20		
55	30	20		
60	* 30	20	3	3
65	* 30	20	* 3	3
70	* 30	* 20	* 3	3
75	* 30	* 20	* 3	3
80	* 30	* 20	* 3	* 3
85	* 30	* 20	* 3	* 3
90	* 30	* 20	* 3	* 3
95	* 30	* 20	* 3	* 3
100	* 30	* 20	* 3	* 3
105	* 30	* 20	* 3	* 3
110	* 30	* 20	* 3	* 3
115	* 30	* 20	* 3	* 3
120	* 30	* 20	* 3	* 3
125	* 30	* 20	* 3	* 3
130	* 30	* 20	* 3	* 3
135	* 30	* 20		* 3
140	* 30	* 20	* 3	* 3
150	* 30	* 20	* 3	* 3
160	* 30	* 20	* 3	* 3
170	* 30	* 20		* 3
180	* 30	* 20	* 3	* 3
190	* 30	* 20		* 3
200	* 30	* 20	* 3	* 3
210	* 30			
220	* 30			
230	* 30			
250	* 30	* 20		* 3

SUS 310S

HEX HEAD CAP SCREW JIS B1180 appendix

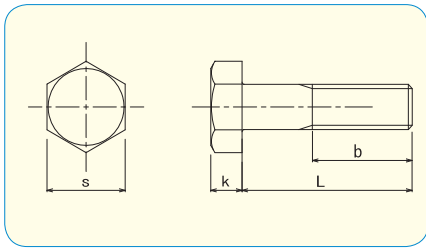

● **Material**
SUS 310S
 Stainless Steel



How to order or inquire: R830-B1180-material code diameter x length

Example: R830-B1180-310 6x25

Material codes: 310 for Stainless Steel 310

	M6	M8	M10	M12	M16	M18	M20	M22	M24	M30
s	10	13	17	19	24	27	30	32	36	46
k	4	5.5	7	8	10	12	13	14	15	19

d		pcs / Box								
L	M6	M8	M10	M12	M16	M18	M20	M22	M24	M30
10	50									
12	50	50								
15	50	50								
16	50	50	30							
20	50	50	30	30						
25	50	50	30	30	20					
30	50	50	30	30	20					
35	50	50	30	30	20					
40	50	50	* 30	* 30	20	20	20			
45	50	50	* 30	* 30	20	20	20			
50	50	50	* 30	* 30	* 20	20	20	20		
55		* 50	* 30	* 30	* 20		20	20		
60	50	* 50	* 30	* 30	* 20	* 20	* 20	* 20	20	20
65		* 50	* 30	* 30	* 20		* 20	* 20	20	20
70	50	* 50	* 30	* 30	* 20	* 20	* 20	* 20	* 20	20
75		* 50	* 30	* 30	* 20		* 20	* 20	* 20	20
80		* 50	* 30	* 30	* 20	* 20	* 20	* 20	* 20	* 20
85		* 50			* 20		* 20	* 20	* 20	* 20
90		* 50	* 30	* 30	* 20	* 20	* 20	* 20	* 20	* 20
100		* 50	* 30	* 30	* 20	* 20	* 20	* 20	* 20	* 20
110			* 30	* 30	* 20		* 20	* 20	* 20	* 20
120			* 30	* 30	* 20		* 20	* 20	* 20	* 20
130			* 30	* 30	* 20		* 20	* 20	* 20	* 20
140			* 30	* 30	* 20		* 20	* 20	* 20	* 20
150			* 30	* 30	* 20		* 20	* 20	* 20	* 20
180					* 20		* 20		* 20	* 20
200					* 20		* 20		* 20	* 20

* ... Half thread

HEX HEAD CAP SCREW JIS B1180 appendix

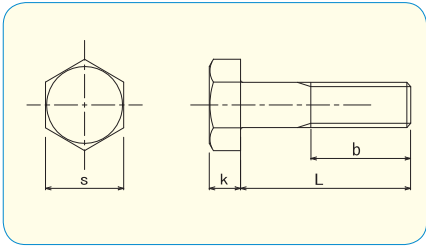

● Material
TITAN



How to order or inquire: R830-B1180-material code diameter x length

Example: R830-B1180-TI 4x16

Material codes: TI for Titanium

	M4	M5	M6	M8	M10	M12	M16	M20
s	7	8	10	13	17	19	24	30
k	2.8	3.5	4	5.5	7	8	10	13

d		pcs / Box							
L	d	M4	M5	M6	M8	M10	M12	M16	M20
8		200	200						
10		200	200	200					
12		200	200	200					
16		200	200	200	100				
20		200	200	200	100	50	50		
25		200	200	200	100	50	50		
30		200	200	200	100	50	50	20	
35		200	200	200	100	50	50	20	
40		200	200	200	100	50	50	20	
45		200	200	200	100	50	* 50	20	
50		200	200	200	100	50	* 50	* 20	15
55				200	100	* 50	* 50	* 20	* 15
60				200	100	* 50	* 50	* 20	* 15
65					* 100	* 50	* 50	* 20	* 15
70					* 100	* 50	* 50	* 20	* 15
75					* 100	* 50	* 50	* 20	* 15
80					* 100	* 50	* 50	* 20	* 15
85						* 50			* 15
90					* 100	* 50	* 50	* 20	* 15
100					* 100	* 50	* 50	* 20	* 15
110							* 50	* 20	* 15
120							* 50	* 20	* 15
130							* 50	* 20	* 15
140								* 20	* 15
150								* 20	* 15



* ... Half thread



HEX HEAD CAP SCREW JIS B1180 appendix

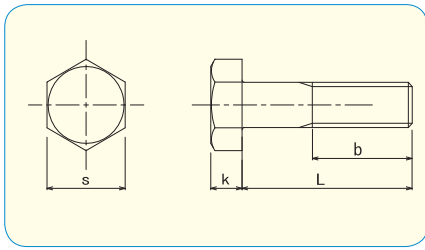

● **Material**
Steel 10.9 / **DISGO**



How to order or inquire: R830-B1180-finish code diameter x length
Example: R830-B1180-DI 10x25
Finish codes: DI for DISGO Plated

	M8	M10	M12	M14	M16	M20	M24
s	13	17	19	22	24	30	36
k	5.5	7	8	9	10	13	15

L \ d		pcs / Box						
		M8	M10	M12	M14	M16	M20	M24
10	100							
12	100							
15	100							
16	100	100						
20	100	100	100					
25	100	100	100					
30	* 100	100	100	60	80	40		
35	* 100	* 100	50	60	70	40		
40	* 100	* 50	* 50	60	70	30	25	
45	* 100	* 50	* 50	* 50	60	30	20	
50	* 100	* 50	* 50	* 50	* 60	30	20	
55	* 100	* 50	* 50	* 40	* 50	30	20	
60	* 100	* 50	* 50	* 40	* 50	* 30	20	
65	* 100	* 50	* 50	* 40	* 50	* 30	15	
70		* 50	* 50	* 40	* 40	* 25	* 15	
75		* 50	* 50	* 30	* 40	* 25	* 15	
80		* 50	* 40	* 30	* 40	* 25	* 15	
90			* 40	* 30	* 30	* 20	* 15	
100			* 40	* 30	* 30	* 20	* 10	

* ... Half thread



High Rustproof Plating



- No Hydrogen-Embrittlement.
- No Cr. contained.
- Special plating for High tensile Fasteners. (class 8.8 / 10.9 / 12.9)