

(*Two-2)

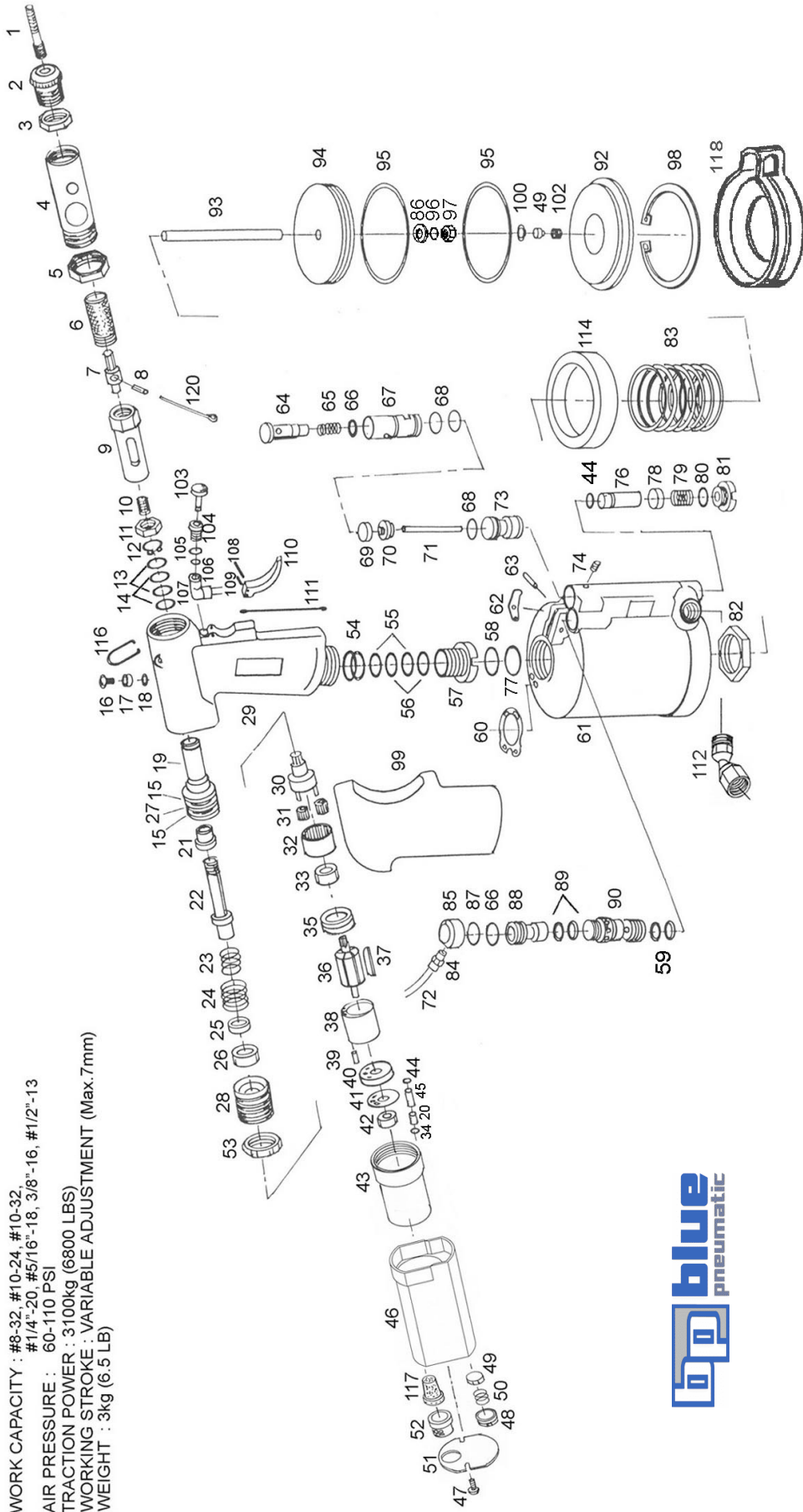

WORK CAPACITY : #8-32, #10-24, #10-32,
 #1/4"-20, #5/16"-18, 3/8"-16, #1/2"-13
 AIR PRESSURE : 60-110 PSI
 TRACTION POWER : 3100kg (6800 LBS)
 WORKING STROKE : VARIABLE ADJUSTMENT (Max. 7mm)
 WEIGHT : 3kg (6.5LB)



BP-60 Spin-Pull-Spin Ultra Air/Hydraulic Rivet Nut Tool (Standard)

(*Two-2) 12/5/2005

INDEX NO.	PART NO.	DESCRIPTION	Q'TY
1	B38-16	Bolt 3/8"-16	1
2	60-3816	Nut Anvil #3/8	1
3	600021	Nut	1
4	6000060	Head	1
5	600016	Nut	1
6	600013	Adjustable Bushing	1
7	600007	Hexagon Bit	1
8	600041	Spring Pin	1
9	6000082	Bolt Bushing	1
10	600076	Spring	1
11	600009	Nut	1
12	600042	Snap Ring	1
13	11502	Ring Washer	2
14	11554	X-Ring Seal	2
15	11501	O-Ring	2
16	02171	Oil Plug	1
17	400017A	Fill Washer	1
18	02197	O-Ring Seal	1
19	600012	Hydraulic Plunger	1
20	6000631	Valve Rod	2
21	600020	Bushing	1
22	600011	Shaft	1
23	600015	Spring	1
24	600045	Spring	1
25	600054	Washer Nut	1
26	B6000	Ball Bearing	1
27	11549	Washer	1
28	600051	Screw Bushing	1
29	600002	Hydraulic Section	1
30	600052	Gear Spinder	1
31	600031	Gear	3
32	600043	Ring Gear	1
33	B608	Ball Bearing	1
34	R06X15	O-Ring	2
35	600055	Front Plate	1
36	82507	Rotor	1
37	82115	Blade	4
38	85209	Cylinder	1
39	25006	Pin	1
40	85230	End Plate	1
41	23211	Motor Gasket	1
42	25004	Ball Bearing	1
43	600061	Motor Housing	1
44	11560	O-Ring Seal	3
45	600048	Tube	2
46	600063	Valve Seat	1
47	600047	Screw	2
48	600071	Screw Bushing	2
49	19312	Rubber plate	3
50	23208	Valve Spring	2
51	600064	Valve Plate	1
52	600065	Exhaust Cap	1
53	600058	Nut	1
54	02116	O-Ring Seal	2
55	10554	O-Ring Seal	2
56	10556	Washer	2
57	600018	Screw Plug	1
58	25022	O-Ring	1
59	R10X1	O-Ring	2
60	600032	Gasket	1
61	600001	Air Cylinder	1
62	500034	Trigger Lever	1
63	02167	Pin	1
64	600023	Valve Rod	1
65	10441	Spring	1
66	10548	O-Ring	2

INDEX NO.	PART NO.	DESCRIPTION	Q'TY
67	600022	Valve Bushing	1
68	10445	O-Ring	3
69	10442	Valve Plate	1
70	600027	Valve Plate Washer	1
71	600040	Pin	1
72	600072	Tube	1
73	600026B	Low Valve Bushing	1
74	600074	Screw M4	1
76	600029	Low Valve Rod	1
77	02170	O-Ring	1
78	11542	Valve Plate	1
79	10544	Spring	1
80	25203	O-Ring	1
81	10550	Plug Screw	1
82	02121	Lock Nut	1
83	600046	Spring	1
84	51058	Tube Connector	1
85	600085	Valve Cap	1
86	48047	Washer	2
87	R123X24	O-Ring	1
88	600084	Valve Stem	1
89	R9X15	O-Ring	2
90	600083	Valve Bush	1
92	500035	Air Cylinder Cap	1
93	600019	Plunger Rod	1
94	500023	Piston Disc	1
95	11531	O-Ring Seal	2
96	48045	Washer	1
97	48048	Nut	1
98	11514	Clip	1
99	600099	Hand Grip	1
100	19314	Retaining Ring	1
102	19313	Spring	1
103	600067	Botton	1
104	600066	Screw Bush	1
105	10748	O-Ring Seal	1
106	R2X1	O-Ring	1
107	600070	Adaptor	1
108	02169	Pin	1
109	02168H	Pin	1
110	02138	Trigger	1
111	500033	Trigger Rod	1
112	T1020S	Universal Joint	1
114	11530	Damping Ring	1
117	600096	Muffler Bush	1
118	11570	Rubber Cushion	1
*** Accessories ***			
1	B12-13	Bolt 1/2"-13	1
1	B516-18	Bolt 5/16"-18	1
1	B14-20	Bolt 1/4"-20	1
1	B10N24	Bolt 10-24	1
1	B10N32	Bolt 10-32	1
1	B8N32	Bolt 8-32	1
2	60-1213	Nut Anvil 1/2"	1
2	60-516	Nut Anvil 5/16"	1
2	60-1420	Nut Anvil 1/4"	1
2	60N10	Nut Anvil #10	2
2	60N8	Nut Anvil #8	1
3	600021	Nut	5
116	54059	Hanging Ring	1
120	600069	Pin	1
*	W24	Wrench 24/27mm	1
*	54005	Hex. Wrench	1
*	11790	Oil Syringe	1