

C9000



Advanced quick acting couplers

You will find all information concerning C 9000 within the online catalogue and learning space of our web-site



Parker Legris connectic

products are available from

MARYLAND METRICS

P.O. Box 261 Owings Mills, MD 21117 USA

ph: (410)358-3130 (800)638-1830

fx: (410)358-3142 (800)872-9329

email: sales@mdmetric.com web: <http://mdmetric.com>

RFQ form: <http://mdmetric.com/rfq.htm>

Parker Legris connectic

products are available from

MARYLAND METRICS

P.O. Box 261 Owings Mills, MD 21117 USA

ph: (410)358-3130 (800)638-1830

fx: (410)358-3142 (800)872-9329

email: sales@mdmetric.com web: <http://mdmetric.com>

RFQ form: <http://mdmetric.com/rfq.htm>



C 9000 advanced quick acting couplers have been designed for pneumatic installations which require frequent connection or disconnection, both quickly and without tools, whether two hoses or a single hose and connection point.

Extensive research and careful design have enabled Legris to provide meaningful benefits to end users through a combination of innovation and proven reliability.

● Comfortable operation

C 9000 ergonomic features ensure maximum comfort and ease of use for the end-user.

In particular :

- **light weight** and robust materials
- **virtually effortless connection and disconnection**
- **improved hand grip** thanks to moulded ridges on the coupler body.

● Superior technological performance

C 9000 technical features ensure **optimal efficiency** of pneumatic machines and air tools with :

- **very high flow** and extremely low pressure loss
- perfectly controlled sealing
- **high impact** composite material resistant to shocks and scratching
- excellent mechanical strength : extending lifetime performance and reliability

● Specifications :

Fluid : compressed air **Working pressure :** 0 to 16 bar

Working temperature : -20° to + 60°C

- Materials :**
- Body : reinforced polymer
 - ARO profile : zamac
 - Sleeve : reinforced polymer
 - Sub-base : nickel-plated brass
 - Spring : stainless steel
 - Balls : stainless steel
 - 'O' Ring : nitrile
 - Probe : nickel-plated brass, reinforced polymer
 - Adaptor : nickel-plated brass and reinforced polymer

● Immediate identification

For immediate visual identification, each model has clear **marking** which indicates :

- the compatible probe profile
- the part number of the coupler body (for restocking).



Flow curves – Pressure loss

Supply pressure = 6 bar

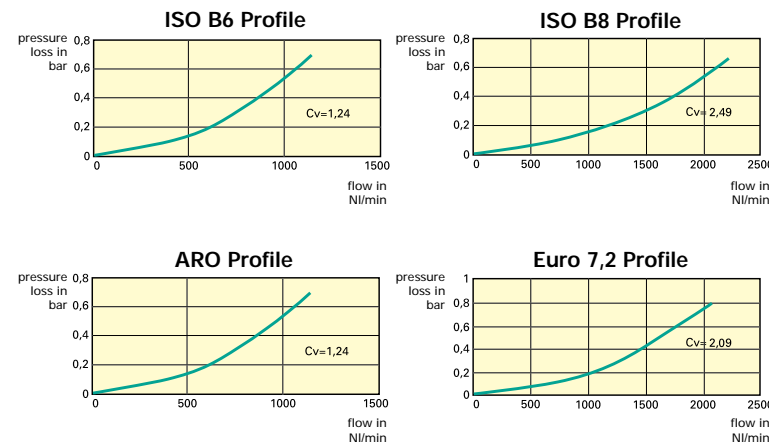

C 9000 advanced quick acting couplers have been specifically designed to meet the operating requirements and safety standards that apply to all industrial organisations.

SAFETY
ISO 4414

● 100% safety

C 9000 advanced quick acting couplers comply with **ISO 4414** and **EN983 Safety** standards since disconnection is by a double twist of the sleeve : a **safety feature** that breaks deliberately with common practice in order to avoid accidental disconnection.

Moreover, even if disconnection is performed rapidly, the safety of the end-user is guaranteed thanks to a **very short vent-time**.

Examples :

- for an ISO B6 profile C 9000 coupler with recoil tubing (6 mm i.d) 6 m length, time to vent (from 6 bar to 0,2 bar) = **350 ms**
- for an ISO B8 profile C 9000 coupler with PVC hose (10 mm i.d) 25 m length, time to vent (from 6 bar to 0,2 bar) = **860 ms**

Even with long lengths of tube, the vent-time of C 9000 couplers is **less than 1 second**.

● guaranteed interchangeability

For replacement, modification or extension of a system, and for maintenance of equipment, interchangeability of couplers is vital for many end-users.

C 9000 has been designed to be directly interchangeable with many other manufacturers, meeting **common worldwide standards** : ISO B, ARO and Euro 7,2 profiles.

Furthermore specific national standard profiles can be matched with a C 9000 **probe adaptor** as a complementary solution.

You can thus adapt the probe profile to the standard you want, immediately overcoming the constraints of compatibility.



rotation in direction of the arrow circuit flushed out probe side.

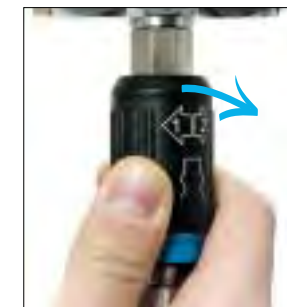

rotation in direction of the arrow disconnection of body and probe.

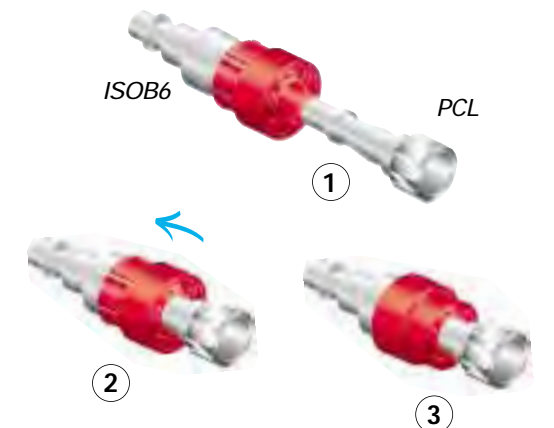
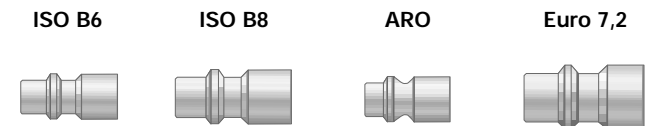

flow : 1250 NI / min (44 cfm)
passage : 5,5 mm



ISO 6150B Profile
SAFETY

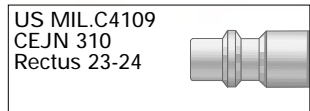

body

9401U male, BSP parallel

C	
G1/4	9401U06 13
G3/8	9401U06 17
G1/2	9401U06 21

9405U male, BSP taper

C	
R1/4	9405U06 13
R3/8	9405U06 17
R1/2	9405U06 21

9414U female, BSP parallel

C	
G1/4	9414U06 13
G3/8	9414U06 17
G1/2	9414U06 21

9410U LF 3000 outlet, with spiral protection spring

ØD (o.d.)	
8	9410U06 08
10	9410U06 10

9421U with hosetail

ØD (i.d.)	
6	9421U06 06
8	9421U06 08
10	9421U06 10

9416U female panel mountable, BSP parallel

C	
G1/4	9416U06 13

probe

9087U male, BSP parallel

C	
G1/4	9087U06 13
G3/8	9087U06 17
G1/2	9087U06 21

9086 female, BSP parallel

C	
G1/4	9086 23 13
G3/8	9086 23 17
G1/2	9086 23 21

9080U LF 3000 outlet, with spiral protection spring

ØD (o.d.)	
8	9080U06 08
10	9080U06 10

9094U with hosetail

ØD (i.d.)	
6	9094U06 06
8	9094U06 08
10	9094U06 10

9440U Y female, BSP parallel

C	
G3/8	9440U06 17

flow : 2400 NI / min (85 cfm)
passage : 8 mm



ISO 6150B Profile
SAFETY

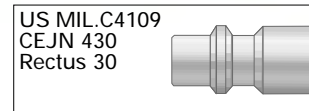

body

9401U male, BSP parallel

C	
G1/4	9401U08 13
G3/8	9401U08 17
G1/2	9401U08 21

9405U male, BSP taper

C	
R1/4	9405U08 13
R3/8	9405U08 17
R1/2	9405U08 21

9414U female, BSP parallel

C	
G1/4	9414U08 13
G3/8	9414U08 17
G1/2	9414U08 21

9410U LF 3000 outlet, with spiral protection spring

ØD (o.d.)	
10	9410U08 10
12	9410U08 12

9421U with hosetail

ØD (i.d.)	
8	9421U08 08
10	9421U08 10
13	9421U08 13

9416U female panel mountable, BSP parallel

C	
G3/8	9416U08 17

probe

9087U male, BSP parallel

C	
G1/4	9087U08 13
G3/8	9087U08 17
G1/2	9087U08 21

9086 female, BSP parallel

C	
G1/4	9086 30 13
G3/8	9086 30 17
G1/2	9086 30 21

9080U LF 3000 outlet, with spiral protection spring

ØD (o.d.)	
10	9080U08 10
12	9080U08 12

9094U with hosetail

ØD (i.d.)	
8	9094U08 08
10	9094U08 10
13	9094U08 13

9440U Y female, BSP parallel

C	
G1/2	9440U08 21

Probe profile interchange adaptor

9090U ISO C to ISO B6 profile adaptor

	9090U06 01
--	------------

9090U PCL to ISO B6 profile adaptor

	9090U06 03
--	------------

C9000



flow : 1250 NI / min (44 cfm)
passage : 5,5 mm



ARO Profile
SAFETY

ARO 210
CEJN 300
Orion 44510
Parker 50
Rectus 14-22

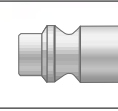

body

9401A male, BSP parallel

C	
G1/4	9401A06 13
G3/8	9401A06 17
G1/2	9401A06 21

9405A male, BSP taper

C	
R1/4	9405A06 13
R3/8	9405A06 17
R1/2	9405A06 21

9414A female, BSP parallel

C	
G1/4	9414A06 13
G3/8	9414A06 17
G1/2	9414A06 21

9410A LF 3000 outlet, with spiral protection spring

ØD (o.d.)	
8	9410A06 08
10	9410A06 10

9421A with hosetail

ØD (i.d.)	
6	9421A06 06
8	9421A06 08
10	9421A06 10

9416A female panel mountable, BSP parallel

C	
G1/4	9416A06 13

probe

9087A male, BSP parallel

C	
G1/4	9087A06 13
G3/8	9087A06 17
G1/2	9087A06 21

9084 male, BSP taper

C	
R1/4	9084 22 13
R3/8	9084 22 17
R1/2	9084 22 21

9086 female, BSP parallel

C	
G1/4	9086 22 13
G3/8	9086 22 17
G1/2	9086 22 21

9080A LF 3000 outlet, with spiral protection spring

ØD (o.d.)	
8	9080A06 08
10	9080A06 10

9094A with hosetail

ØD (i.d.)	
6	9094A06 06
8	9094A06 08
10	9094A06 10

9440A Y female, BSP parallel

C	
G3/8	9440A06 17

flow : 2000 NI / min
passage : 7,2 mm



Euro Profile
SAFETY

CEJN 320
Rectus 25-26

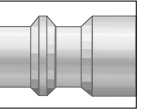

body

9401E male, BSP parallel

C	
G1/4	9401E07 13
G3/8	9401E07 17
G1/2	9401E07 21

9414E female, BSP parallel

C	
G1/4	9414E07 13
G3/8	9414E07 17
G1/2	9414E07 21

9410E LF 3000 outlet, with spiral protection spring

ØD (o.d.)	
10	9410E07 10
12	9410E07 12

9421E with hosetail

ØD (i.d.)	
8	9421E07 08
10	9421E07 10
13	9421E07 13

9416E female panel mountable, BSP parallel

C	
G3/8	9416E07 17

probe

9087E male, BSP parallel

C	
G1/4	9087E07 13
G3/8	9087E07 17
G1/2	9087E07 21

9086 female, BSP parallel

C	
G1/4	9086 25 13
G3/8	9086 25 17
G1/2	9086 25 21

9080E LF 3000 outlet, with spiral protection spring

ØD (o.d.)	
10	9080E07 10
12	9080E07 12

9094E with hosetail

ØD (i.d.)	
8	9094E07 08
10	9094E07 10
13	9094E07 13

9440E Y female, BSP parallel

C	
G1/2	9440E07 21

To complete its range of C 9000 advanced quick acting couplers, Legris offers a wide range of compatible technical tubes and hoses :

- polyurethane recoil tubing
- braided PVC hose and hose clips

