

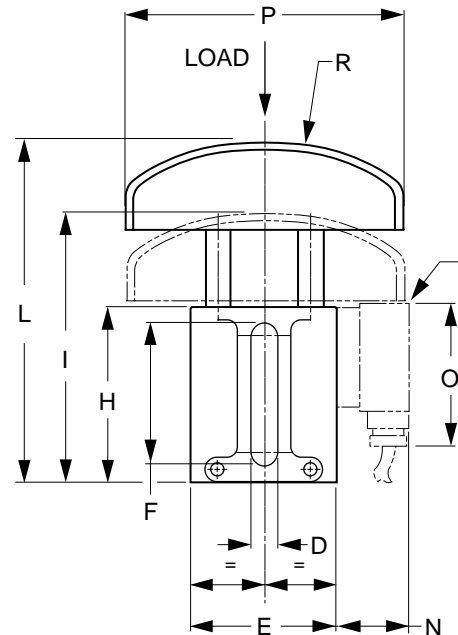

# TA Type Tensioner

For 3/8" to 1-1/2" Pitch Roller Chains  
Spring-Loaded

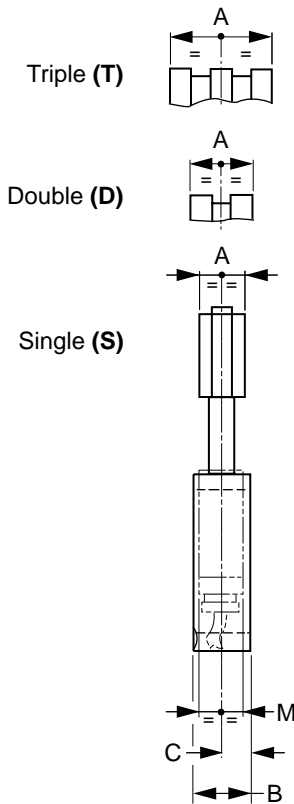

Integral "End-of-stroke" sensing switch available on special order.

Automatically keeps the tension constant.



**MATERIAL:** Head – Polyethylene (UHMW-PE)  
Base – High-Tensile Die-Cast Aluminum Alloy  
Slide Arms – High-Tensile Steel (Zinc Plated)  
**MAX. OPERATING TEMPERATURE:** 65°C (149°F)

Catalog Number	Load (N)		Chain Pitch	A	B	C	D	E	F	G	H	I	L	P	R	M	N	O
	Min	Max																
QCT-TA103S	130	250	3/8" x 7/32"	20	23	12.5	11	56.2	7	58	74	115	143	140	120	-	-	-
QCT-TA103D				20														
QCT-TA103T				25														
QCT-TA104S	130	250	1/2" x 5/16"	20	23	12.5	11	56.2	7	58	74	115	143	140	120	-	-	-
QCT-TA104D				20														
QCT-TA104T				35														
QCT-TA205S	180	420	5/8" x 3/8"	20	28	15	12.5	70.5	9	70	87	128	164	140	140	-	-	-
QCT-TA205D				25														
QCT-TA205T				41.5														
QCT-TA206S	180	420	3/4" x 7/16"	22	28	15	12.5	70.5	9	70	87	128	164	140	140	-	-	-
QCT-TA206D				30														
QCT-TA206T				49														
QCT-TA308S	300	650	1" x 17 mm	25	33	17.5	14.5	82	9	86	104	145	187	140	160	21	35	70
QCT-TA308D				45														
QCT-TA308T				78														
QCT-TA310S	300	650	1-1/4" x 3/4"	25	33	17.5	14.5	82	9	86	104	145	187	140	160	21	35	70
QCT-TA310D				54														
QCT-TA310T				90														
QCT-TA312S	300	650	1-1/2" x 1"	25	33	17.5	14.5	82	9	86	104	145	187	140	160	21	35	70
QCT-TA312D				71														
QCT-TA312T				119														

All dimensions are in mm unless otherwise noted.

**QTC, Econobelt & Zetasassi products are available from: MARYLAND METRICS**  
**P.O.Box 261 Owings Mills, MD 21117 USA E-mail: sales@mdmetric.com**  
**phones: (410)358-3130 (800)638-1830 faxes: (410)358-3142 (800)872-9329 url: http://mdmetric.com**  
 copyright 2003 maryland metrics/qtc/econobelt/zetasassi